

Flap tools

Unmounted flap wheels, set FR



SET FR

Set with high-output electric straight grinder UGER 15/60 SI with electronic rotational speed control (2,800–5,900 RPM)

Contents:

1 pc. each of:

- Electric straight grinder UGER 15/60 SI with electronic rotational speed control (2,800–5,900 RPM)
- Collet with diameter 6, 8 and 12 mm
- Unmounted flap wheel FR 15030 A-COOL 60
- Unmounted flap wheel FR 15030 A-COOL 120
- POLINOX mounted flap wheel PNL 15050 A 100
- Arbor FR/VR 12/25,4 100-165
- Arbor PCLB 8/13/26

2 pcs. each of:

- POLICLEAN wheels PCLS 15013/13

Advantages:

- Optimal, stepless rotational speed regulation for the use of unmounted flap wheels and POLINOX wheels.
- Coordinated selection of the most common versions.

Ordering notes:

- Detailed information and ordering data on tool drives can be found in catalogue section 9.

D [mm]	L x B x H [mm]	EAN 4007220		Description
150	587 x 285 x 162	777350	1	SET FR 15030 UGER 15/60 230 V

Arbors FR/VR

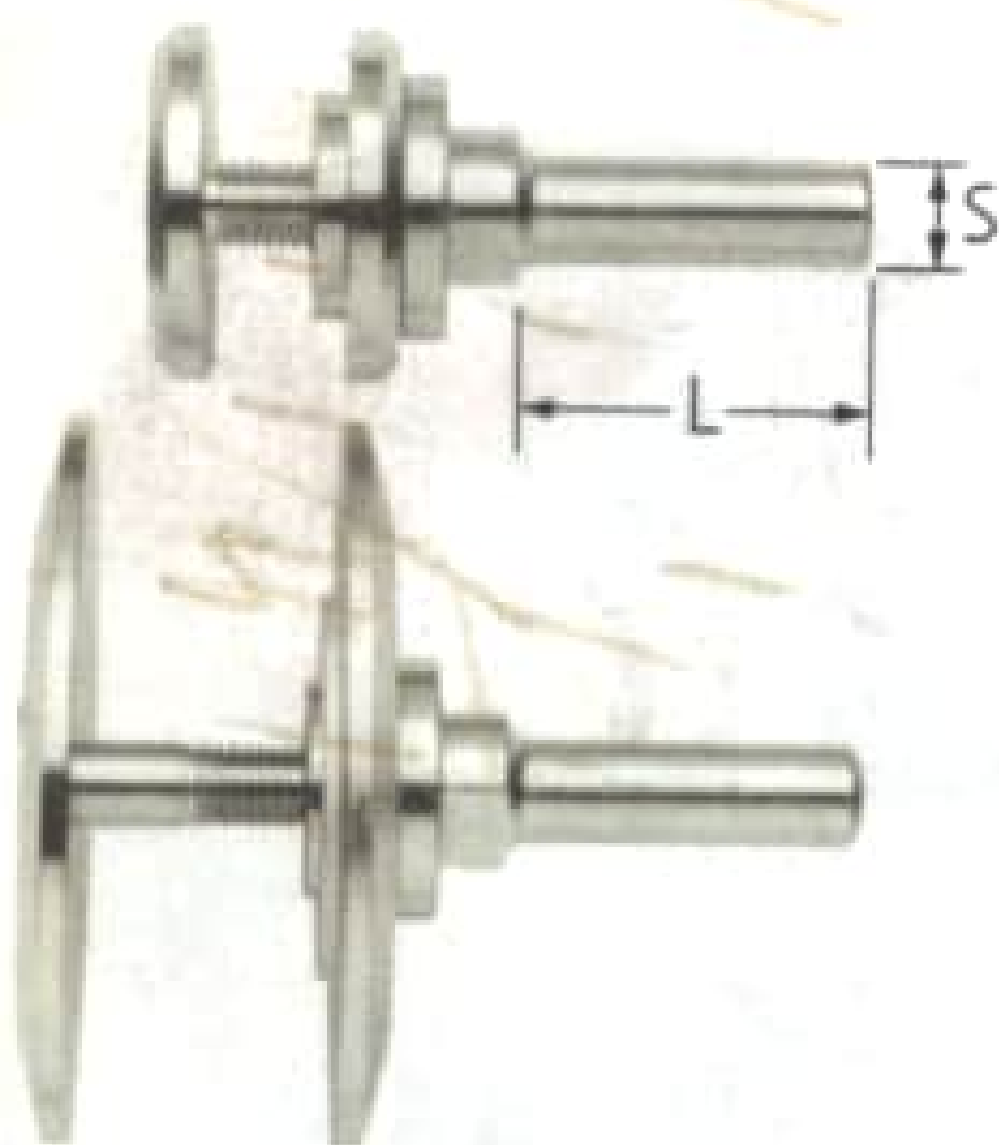

Type with clamping flange

For mounting PFERD unmounted flap wheels. The clamping flanges are designed to lie countersunk in the tool.

Advantages:

- Can be used face-down very close to edges and in angles thanks to special clamping system.

Ordering notes:

- Included in delivery: Arbor, clamping diameter of 12 mm, 2 flanges and matching screws (for different unmounted flap wheel widths).
- We manufacture arbors with morse cones on request.

Suitable for tool dia. [mm]	Suitable for centre hole dia. [mm]	S [mm]	L [mm]	Clamping width [mm]	EAN 4007220		Description
100, 150, 165	25.4	12	40	25–50	479643	1	FR/VR 12/25,4 100-165
200, 250	44	12	40	25–50	479650	1	FR/VR 12/44,0 200-250

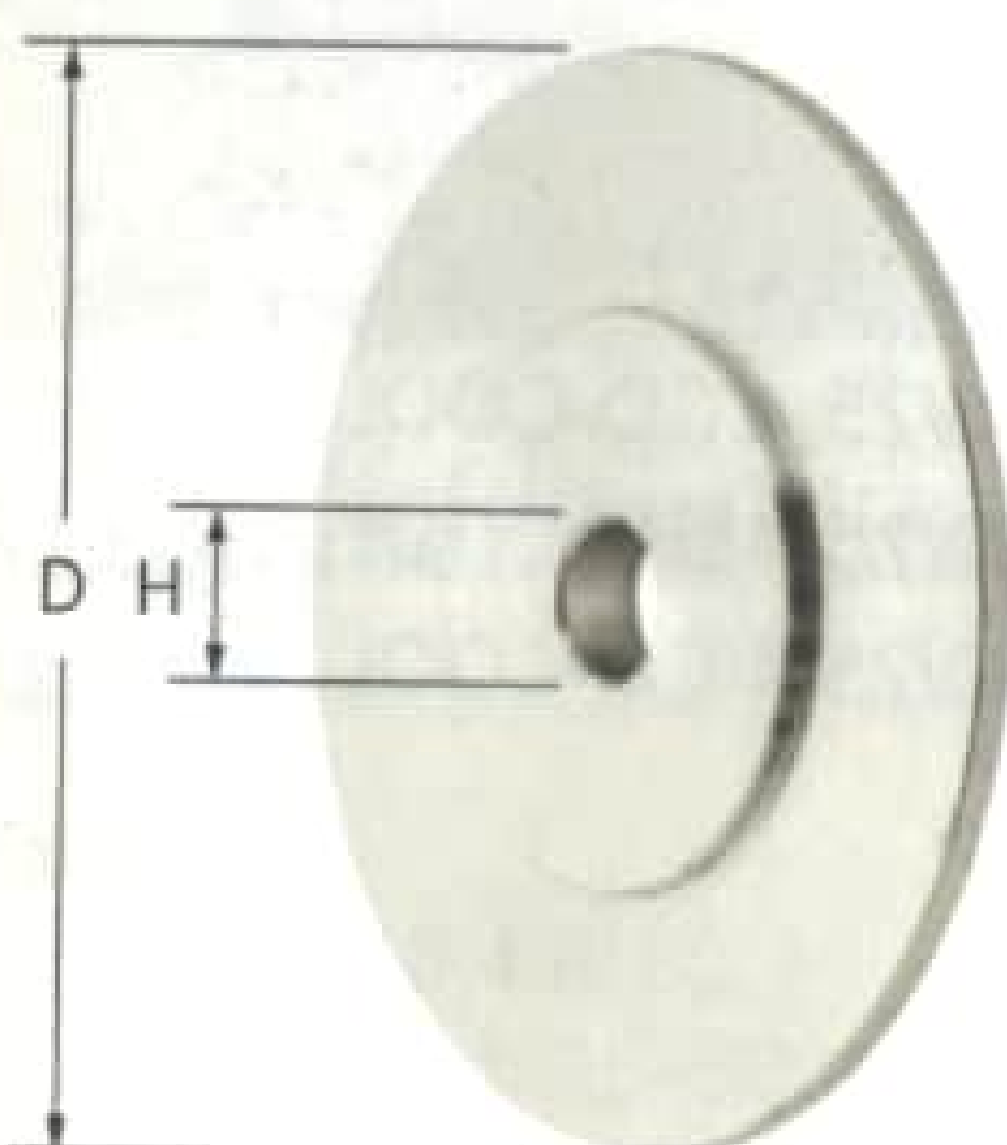

Reducing flanges for unmounted flap wheels

For mounting unmounted flap wheels and POLINOX unmounted flap wheels on drive spindles. The clamping flanges are designed to lie countersunk in the tool.

Advantages:

- Can be adapted to an existing drive spindle by drilling.
- Can be used face-down very close to edges and in angles thanks to special clamping system.

Ordering notes:

- Included in delivery: 1 pair

Suitable for tool dia. [mm]	D [mm]	H [mm]	Max. H [mm]	EAN 4007220		Description
150, 165	40	12	22.2	509876	1	RF FR 150-165 Bo. 12-22,2
200, 250	83	12	40	498460	1	RF FR 200-250 Bo. 12-40